



**BADGER'S**

# **HOBBY ABRASIVE GUN MODEL 260**

***CAUTION: FOLLOW THESE SAFETY RULES***

1. Always wear goggles, mask and gloves when using this tool.
2. Keep children and pets away from the work area.
3. All persons who enter the work area must wear goggles, gloves and face mask.
4. Remove all flammable liquids from the work area. Sparks could be created, capable of igniting an explosion or fire.
5. **NEVER POINT THE ABRASIVE GUN AT ANYONE.** Hold your Hobby Abrasive Gun at an angle to the item being blasted so the abrasive does not rebound directly to you.
6. Never use the abrasive gun at an air pressure over 45 p.s.i.
7. Never place hands or skin directly in line with Abrasive Gun tip when operating it.
8. Disconnect compressor and air hose before servicing your Hobby Abrasive Gun.

***Not recommended for use by children without adult supervision. The Abrasive Gun is not a toy and should never be pointed at people or pets!***

**CAUTION: READ CAREFULLY AND UNDERSTAND ALL INFORMATION BEFORE USING THIS PRODUCT.**

# **CAUTION: READ CAREFULLY AND UNDERSTAND ALL INFORMATION BEFORE USING THIS PRODUCT**

## **TO OPERATE**

1. Select a well lighted, well ventilated work area. Remove anything which might be damaged by the flying abrasive. Make sure you keep your compressor and any other motors as far away as possible from the work area. Flying abrasive can damage the bearings of motors and electronic tools. Metal cabinets specifically designed for blasting are commercially available. A cardboard or wood carton with one end open or removed can serve as a booth to help capture the abrasive for easier clean up. Wood or cardboard particles may contaminate the abrasive, making re-use of abrasive impossible.
2. **TO USE WITH PROPEL CAN:** Before attaching regulator valve to Propel can, turn knob counter clockwise several times. Then attach regulator valve to Propel can by turning clockwise. **IMPORTANT:** If propellant begins to escape while attaching to valve (see warning about freezing skin and eye tissue-on Propel can) turn counter-clockwise until leakage stops. Next attach regulator valve to hose, then remove 1/4" pipe thread fitting from other end of hose and attach abrasive gun by turning clockwise. To turn on air, open knob on top of valve clockwise slightly until desired pressure is reached. **TO USE WITH COMPRESSOR:** To attach your air hose to the compressor, use the one end that has a 1/4" fitting and secure it to the compressor. Next attach the air hose to the gun, hold the gun in your left hand, by the jar. Attach the air hose to the valve by turning clockwise. Make sure both ends of the air hose are secure.
3. Place the OSHA approved face mask (provided with your set), over your nose and mouth. Pull the elastic band over your head. Put on safety goggles, or hood with plastic safety shield to protect your eyes. If eye shield is held in your hand while blasting, wear heavy gloves to avoid skin abrasions.

4. Unscrew the glass jar from the gun and fill 3/4 full with aluminum oxide abrasive provided. Screw the jar with the abrasive back onto the gun securely and set the gun near your work area.
5. Before operating, adjust the air pressure regulator on your compressor to 30 PSI. Experience with your Abrasive Gun will dictate the optimum air pressure needed for your particular job. **NEVER EXCEED 80 PSI.**
6. Place small objects in the cabinet. This will trap most of the abrasive, which can be filtered with a 100 mesh screen and re-used.
7. Test you gun first on an inconspicuous area of the item to be blasted. If the base material is being pitted or damaged, use less air pressure.
8. Note: If pick-up adjustment screw (50-265) is not into main shaft (50-262) hole and abrasive is clogged in the main shaft, the shaft may be propelled out of the body when trigger is depressed.

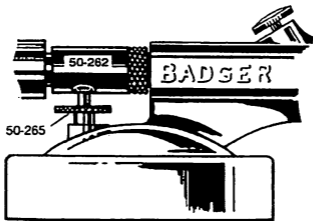

Always make sure pick-up adjustment screw is positioned in the main shaft hole before operating

### HANDY TIPS

The following suggestions may help you when working with the material listed below. Because each situation is unique, it is always best to prac-

# BADGER ABRASIVE GUN REPLACEMENT PARTS/MODEL 260

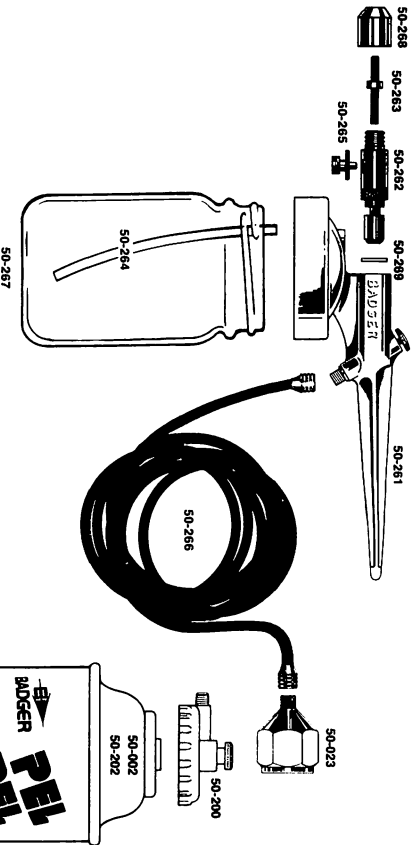

Part No.	Description	Part No.	Description
50-268	Propel Regulator	50-262	Main Shaft
50-263	Small Propel Can	50-263	Abrasive Tip
50-002	Large Propel Can	50-264	Pick-up Tube
50-202	12 oz Bottle Aluminum Oxide	50-265	Pick-up Adjustment Screw
50-260	Body with Valve	50-023	1/4" Pipe Thread Fitting
50-261		50-266	Air-hose
		50-267	4 oz. Jar
		50-268	Collar
		50-269	"O" Ring
		50-270	5 lb. Bottle Aluminum Oxide
		50-271	Replacement kit (part includes 50-263/50-264/50-265)

tice on an inconspicuous area to perfect your own technique and skill.

### **FOR REMOVING PAINT OR RUST FROM METAL**

Work at a distance of 0-1 inch from the object, using 40 p.s.i.

### **FOR REMOVING PAINT FROM WOOD OR SMOOTHING WOOD**

Work at a distance of 0-2 inches from the object, start at a lower air pressure to avoid damaging the wood. Slowly increase the pressure until you feel that the pressure is right for your project. Recommended pressure is 30-40 PSI. Use an even, brushing motion at about a 45° angle.

### **FOR ETCHING IN GLASS**

Mask the area to be etched with a stencil made of thin metal, plastic, cardboard or glass etching tape. Use an even brushing motion across the stencil until the desired effect is reached. Recommended starting pressure is 40 PSI.

General, the higher the air pressure (up to 80 PSI) and the closer the tip is to the surface, the faster the object will be completed. Replace the tip when you notice air and abrasive material dribbling from the tip and your working speed is reduced. Use replacement Kit 50-271.

### **MAINTENANCE**

Careful maintenance of your Hobby Abrasive Gun is essential if it is to continue to work effectively.

1. Store abrasives in a dry area. Used or old abrasives must be filtered with a 100 mesh screen to remove dirt and lumps which would clog the gun.\*

\*When you need to purchase additional abrasive, always use Badger's replacement abrasive 50-260 (12 oz) or 50-270 (5 lb.)

**2 IF USING A TANK MOUNTED COMPRESSOR**—Before each use, disconnect your air compressor from its power source. Depressurize the air tank, remove the drain plug and drain all moisture from the tank. Moisture and wet materials cause the majority of blasting problems. Keep the compressor off damp basement floors.

If you notice moisture particles being sprayed through the tip of the gun while you are blasting, install a moisture trap (Badger 50-051) on your air compressor.

**3** Replace the tip when dribbling of abrasive from the tip becomes noticeable and when working speed is reduced. Use Replacement Kit 50-271.

**4** Maintain your air compressor properly. Insufficient air volume and pressure will greatly diminish the effectiveness of the Hobby Abrasive Gun.

## **TROUBLESHOOTING**

<b>PROBLEM</b>	<b>AREA TO CHECK</b>	<b>SOLUTION</b>
Sputtering	Loose material tip	Tighten tip
	Abrasive collecting inside the tip	Remove tip and clean thoroughly, replace
	Loose air hose fitting	Tighten
Failure to operate	Damp material clogging gun	Replace with dry abrasive
	Material tube clogged	Remove tube and clean thoroughly

BA-315/Made and printed in U.S.A. 9/06



**BADGER AIR-BRUSH CO.**

9128 W. BELMONT AVE. · FRANKLIN PARK, IL 60131